

RESOLUTION NO. 93-125

**A RESOLUTION OF THE CITY COUNCIL OF THE CITY OF EL PASO DE ROBLES AUTHORIZING THE EXECUTION OF A PERMIT TO ENTER BETWEEN THE CITY OF EL PASO DE ROBLES AND THE DEPARTMENT OF GENERAL SERVICES, OFFICE OF REAL ESTATE AND DESIGN SERVICE FOR AIRPORT PARCEL 58**

**WHEREAS**, applicant, Department of General Services, Office of Real Estate and Design Service, is seeking permission to conduct a site analysis study on Airport Parcel 58 to qualify the airport site identified in Exhibit "A" for a California Highway Patrol Air Operations facility.

**WHEREAS**, the standard site analysis process requires specific authorizations by the property owner, and

**WHEREAS**, as owner of record for Airport Parcel 58, the City of El Paso de Robles must provide specific authorization for said Permit, and

**WHEREAS**, as owner of record for Airport Parcel 58, the City of El Paso de Robles requires applicant, Department of General Services, Office of Real Estate and Design Service, to complete the site analysis study within twelve months or said authorization is withdrawn.

**NOW, THEREFORE, BE IT RESOLVED** that the City Council of the City of El Paso de Robles authorizes the execution of a Permit to Enter agreement for a site analysis study to qualify the airport site identified in Exhibit "A" for a California Highway Patrol Air Operations facility on Airport Parcel 58.

**PASSED AND ADOPTED** by the City Council of the City of El Paso de Robles, this 6th day of July, 1993, on the following vote:

**AYES:** Heggarty, Macklin, Martin, and Iversen

**NOES:** None

**ABSENT:** Picanco

CITY OF EL PASO DE ROBLES



MAYOR CHRISTIAN E. IVERSEN

ATTEST:

  
RICHARD J. RAMIREZ, CITY CLERK

# EXHIBIT "A"

## LOCATION MAP

Property is approximately five acres on the Southwest corner of the intersection of Taxiway "A" and Satellite Drive as indicated by the crosshatched area in the diagram below.

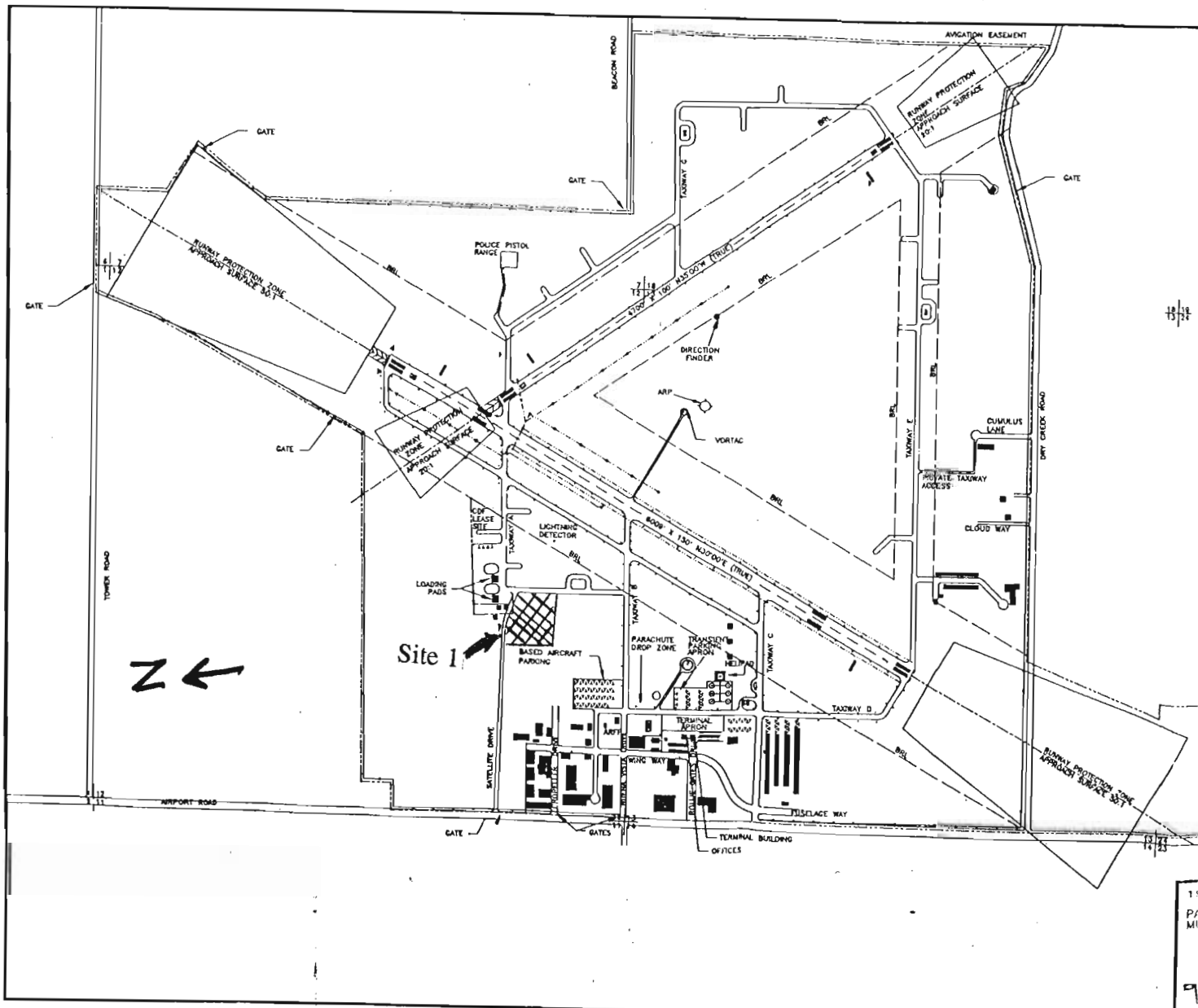

**PERMIT TO ENTER**

Permission is hereby granted Department of General Services, Office of Real Estate and Design Service (OREDS) or their authorized representatives to enter upon the City of El Paso de Robles owned property delineated as Site 1 on the attached Exhibit "A" for the purpose of doing a siting study for the possible development of a California Highway Patrol facility. The study includes, but is not limited to, the right to do soil surveys, telecommunication testing and environmental studies;

This permission to enter is given with the understanding that OREDS agrees to hold the City of El Paso de Robles harmless and indemnify from any damages or claims of damages resulting from, or alleged to result from, their activities on this property.

This permission to enter is given with the understanding that this authorization will expire August 1, 1994.

This permission to enter is given with the understanding that the City of El Paso de Robles will not enter into a lease agreement for said property with another - during the authorization period.

Further, OREDS a property will be done requirements and that and the property shall currently exists.

*Shelley will return original permit to me when signed.*

ities conducted on this local regulatory agency perty shall be repaired he same condition as

OREDS will be respo Richard J. Ramirez, City Park Street, Paso Robles,

ng their studies with Paso de Robles, 910 umber (805) 237-3888.

**PERMISSION IS HEREBY GRANT  
CITY OF EL PASO DE ROBLES**

By Christian E. Iversen  
Christian E. Iversen  
Mayor

\_\_\_\_\_  
Date

**TO THE DEPARTMENT OF GENERAL SERVICES  
OFFICE OF REAL ESTATE AND DESIGN SERVICES**

By Norton R. Chapman, Jr  
Norton R. Chapman, Jr  
Area Manager

\_\_\_\_\_  
Date